

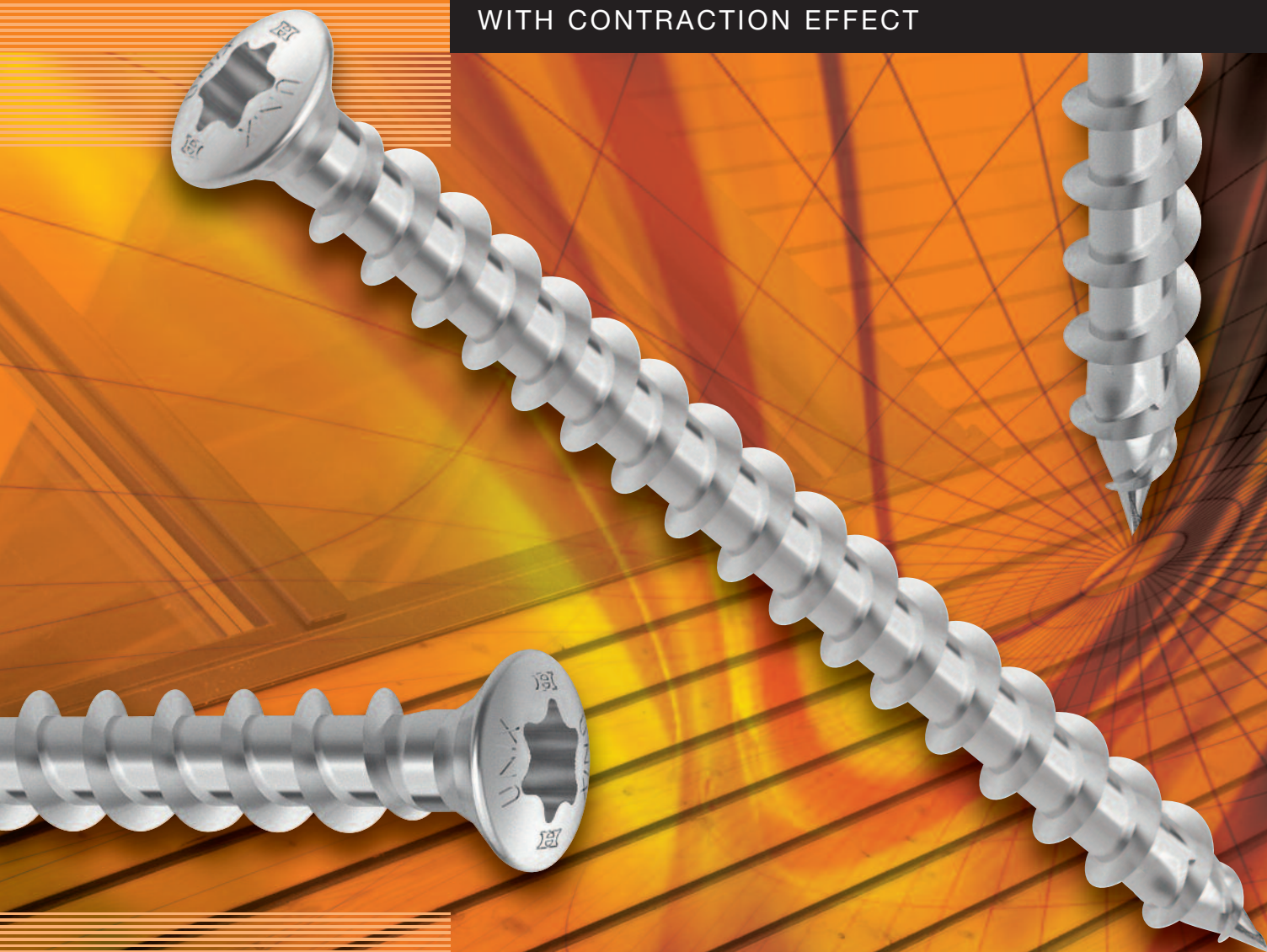

# ***HECO-UNIX-top Cladding Screw***

THE UNIQUE CLADDING SCREW  
WITH CONTRACTION EFFECT



## **APPLICATION EXAMPLES**



*Façade construction*



*Secure and reliable façade fixing*



*Louvred façades*



# CONTRACTION EFFECT

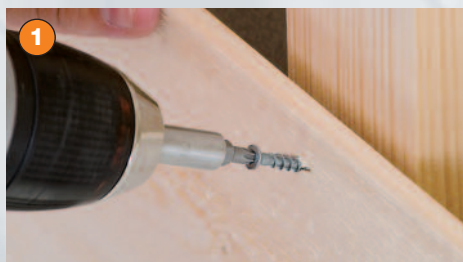

**1**  
The variable pitch of the HECO-UNIX full thread takes hold



**2**  
The smaller thread pitch means that the boards are clamped firmly together



**3**  
Gap free axial fixing of the timber board via the HECO-UNIX full thread

## PRODUCT CHARACTERISTICS

### HECO-UNIX-top full thread

- Contraction effect thanks to the full thread with variable thread pitch
- Axial fixing of component
- Reduced spreading effect thanks to the HECO-TOPIX® tip

### Raised countersunk head and T-drive

- Small head diameter
- Raised head



## THE ADVANTAGES

- Thanks to the contraction effect, the thread draws the timberwork onto the sub-structure. This allows for a flush finish
- Higher loads can be achieved to partial thread screws. The number of screws required is reduced considerably
- Durable, sturdy connection, as the timber components are fixed axially via the full thread
- No predrilling required
- Simple, concealed fastening thanks to the small head
- The small head results in reduced water logging

### The HECO-UNIX-top Cladding Screw with contraction effect

Timber façades are becoming increasingly popular in both new builds and renovations. This application places high demands on fastenings. The façade must be securely fixed to the sub-structure and the fixings should be invisible or attractive to look at. In addition, the structure must be permanently sound if it is constantly exposed to the weather. The HECO-UNIX-top façade screw is the perfect solution to all of these requirements. The full thread with its variable thread pitch reliably draws the façade boards onto the sub-structure without the head having to be countersunk deep

into the timber. The façade is secured axially via the thread, which increases the pull-out strength. This results in fewer fastening points and an ultimately more economical façade construction. Thanks to the full thread, the sole function of the head is to fit the screw drive. As such, the HECO-UNIX-top façade screw has a small raised head, which allows simple, concealed installation preventing any water penetration through the screw. The screws are made of stainless steel A2, which safely eliminates the problem of corrosion caused by exposure to weather – for instance, rusting screws.

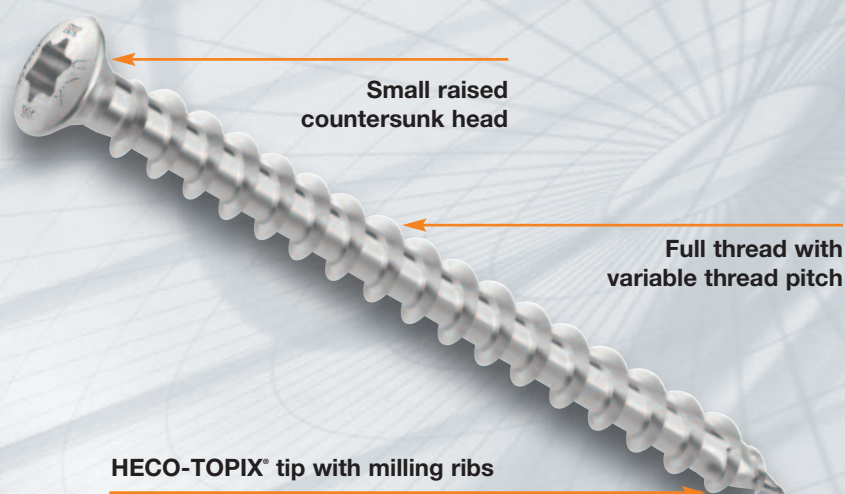

### HECO-UNIX-top range: raised countersunk head full threaded, T-drive, stainless steel A2, coated

Size D x L (mm)	Article No.	Recess	Box	Packing unit (pcs.)
4,5 x 50	45898	T-20	VAR2	200
4,5 x 60	45900	T-20	VAR2	200
4,5 x 70	45902	T-20	VAR3	200
4,5 x 80	45904	T-20	VAR3	200
5,0 x 40	45427	T-20	VAR2	200
5,0 x 50	45429	T-20	VAR2	200
5,0 x 60	45431	T-20	VAR2	200
5,0 x 70	45433	T-20	VAR3	200
5,0 x 80	45435	T-20	VAR3	200



### HECO-Schrauben GmbH & Co. KG

Dr.-Kurt-Steim-Straße 28  
D-78713 Schramberg  
Tel.: +49 (0) 74 22 / 9 89-0  
Fax: +49 (0) 74 22 / 9 89-200  
E-mail: [info@heco-schrauben.de](mailto:info@heco-schrauben.de)  
Internet: [www.heco-schrauben.com](http://www.heco-schrauben.com)



Your specialist dealer: